

FEELED D bar 2 LINE

LED for display, cabinet & furniture



FEELED D bar 2 LINE

FEELED D Bar2 LINE은 D Bar2 HO와 똑같은 동일하나, 소비전력을 낮춰 만든 보급형으로 DC BAR 대중화를 위하여 필룩스에서 새로운 대안으로 개발한 제품입니다.



연결



규격

표준제품

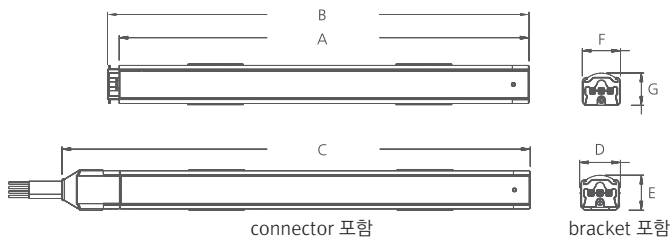

Model Name	입력전압 (V)	소비전력 (W)	A (mm)	B (mm)	C (mm)	D (mm)	E (mm)	F (mm)	G (mm)
LIDB 3AB24M/KR	3	2.9	187	192	209	16	14	15	12.5
LIDB 4AB24M/KR	4	5.8	280	285	302	16	14	15	12.5
LIDB 7AB24M/KR	7	11.6	560	565	582	16	14	15	12.5
LIDB 11AB24M/KR	11	17.4	840	845	862	16	14	15	12.5
LIDB 15AB24M/KR	15	23.2	1,118	1,123	1,140	16	14	15	12.5

LED Converter

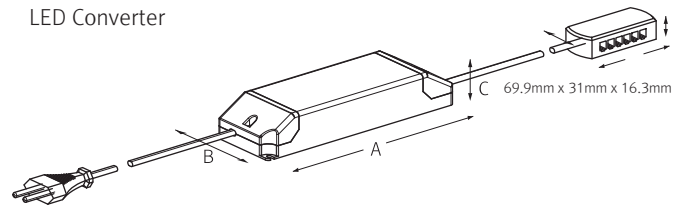

Model name	A (mm)	B (mm)	C (mm)
FLC30-24V/K	150	41	31
FLC75-24V/K	180	60	32

직하조도 및 배광곡선

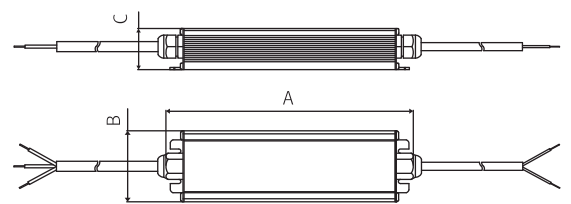
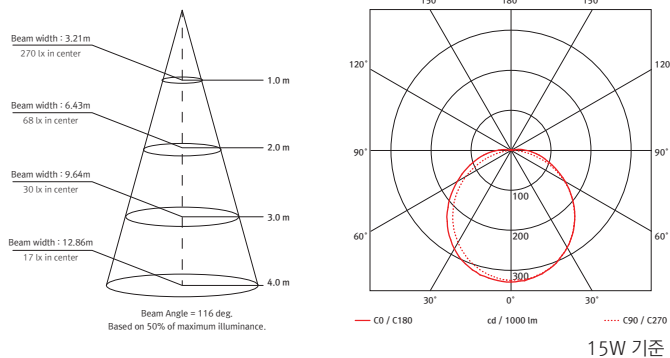

Model name	A (mm)	B (mm)	C (mm)
FLC200-24V/K	229	68	39

사양

Model name	입력전압	소비전력	소비전류	광속	광효율	연색성	색온도	무게
LIDB 3AB24M/KR	DC24V	3W	0.125A	222 lm	74 lm/W	Ra > 85	3,000K/4,000K/5,700K	25g
LIDB 4AB24M/KR	DC24V	4W	0.166A	296 lm	74 lm/W	Ra > 85	3,000K/4,000K/5,700K	36g
LIDB 7AB24M/KR	DC24V	7W	0.291A	518 lm	74 lm/W	Ra > 85	3,000K/4,000K/5,700K	71g
LIDB 11AB24M/KR	DC24V	11W	0.458A	814 lm	74 lm/W	Ra > 85	3,000K/4,000K/5,700K	105g
LIDB 15AB24M/KR	DC24V	15W	0.625A	1,110 lm	74 lm/W	Ra > 85	3,000K/4,000K/5,700K	158.5g

FEELED D bar 2 LINE

LED for display, cabinet & furniture



D bar 2 LINE 3W 192mm



D bar 2 LINE 4W 285mm



D bar 2 LINE 7W 565mm



D bar 2 LINE 11W 845mm



D bar 2 LINE 15W 1,123mm



악세사리

㉠ 연결선

HDBPTC	HDBPTC1	HDBPTC2	HDBPTC4	HDBPTC6
150mm	300mm	600mm	1,200mm	1,800mm

㉡ 전원선 : HDBPC (2,500mm)

㉢ 고정클립 : HDB-BRACKET1 "A"

㉣ 각도클립 (15° & 40°) : HDB-BRACKET2 "A"

㉤ LED converter

Part No	FLC30-24V/K	FLC75-24V/K
Capacity	30W 24V	75W 24V

㉥ LED converter

Part No	FLC200-24V/K
Capacity	200W 24V

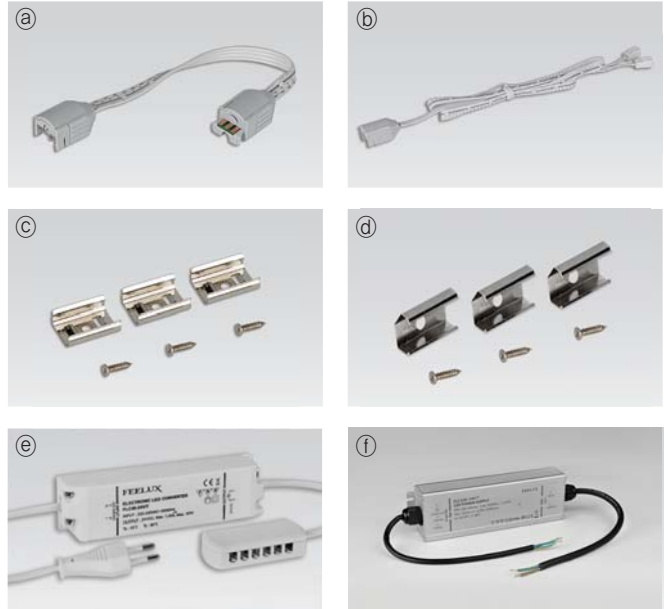

설치방법

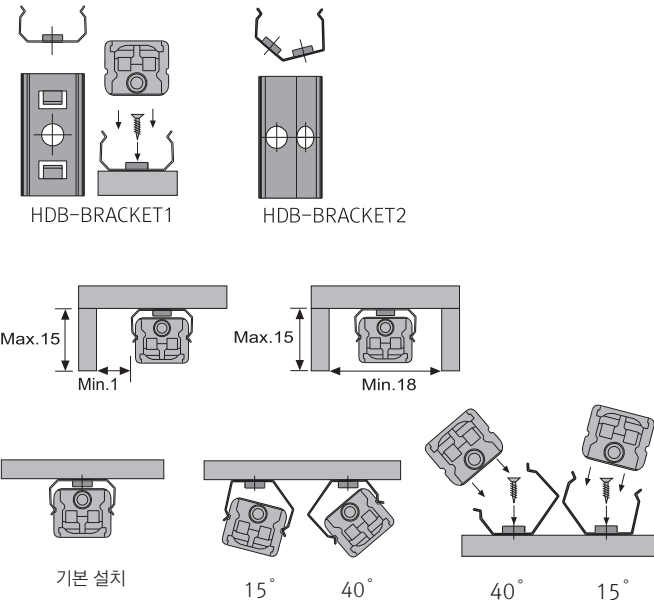

주의

최대연결개수 : 직렬 연결시 최대 15W 기준 3개 (45W)
컨버터 별 최대 연결 개수는 전력의 80%

Model Name	컨버터 별 최대 연결개수		
	24V/30W	24V/75W	24V/200W
LIDB 3AB24M/KR	8	19	54
LIDB 4AB24M/KR	6	14	40
LIDB 7AB24M/KR	3	8	23
LIDB 11AB24M/KR	2	5	15
LIDB 15AB24M/KR	1	3	11